



SOUDA-CRRA
SOUDA-CLRA

DUAL ZONE DISPLAY CASE (Refrigerated+Ambient)

Integrated compact design that provides an effective solution for limited spaces, perfectly showcasing both chilled and ambient products simultaneously, increasing product visibility and accessibility.



Two Zones Ones Solution:

Display and presentation is everything, our revolutionary dual-zone display unit isn't just another refrigerator – it's your partner in creating an unforgettable shopping experience that drives sales and attracts your customers attention.



Enhanced Display Experience:

With our state-of-the-art 3000K LED lighting system featuring 7 integrated magnetic undershelf lights, complemented by extra-clear tempered glass that ensures maximum product visibility



Seamless Access:

Innovative double glazing swing doors feature a self-closing system to maintain optimal temperature, while built-in stoppers ensure easy access for restocking. The doors are designed for convenience, allowing effortless removal for deep cleaning and maintenance.



Adjustable Shelving System:

Versatile 7-level shelving system that can be adjusted in height and tilt, offering flexible product presentation and arrangements in a sleek design, making it much easier to load and unload products on the desired shelf.



SOUDA-CxRA



BENEFITS AND USES

Improved customer experience:

- the dual-zone display can create a more inviting and appealing shopping experience for customers. This can lead to increased customer satisfaction and loyalty. And increased visibility: The dual-zone display feature works by dividing the display case into two separate zones. One zone is kept at a cooler temperature, while the other zone is kept at a warmer temperature. This allows businesses to display a wider variety of products, including both chilled and ambient products.

Mobility:

- The unit is equipped with 6 caster wheels which eases cleaning and housekeeping around the unit.

Accessibility:

- each cooled and dry zone has its own separate swing door, which makes it easier to load and unload products in the desired shelf. In addition, shelves are adjustable, which gives the user the freedom to adapt shelf height and tilt.

Extended shelf life:

- The cold air that circulates within a display helps to extend the shelf life of fresh produce and other perishable goods. This can save businesses money on food waste.

MODEL FEATURES (TOP 5 FEATURES):



Double Swing Doors:

For ease of access and maintenance, the doors are not only double swinging but also fully removable, facilitating deep cleaning.



Enhanced Safety and Visibility:

The front, top, and side walls are fitted with extra clear, safety-reinforced tempered glass, enhancing the merchandiser's display effects and ensuring durability.



Heavy-Duty Base Structure:

Designed to safely support the unit's weight, the robust base is equipped with caster wheels, improving mobility and placement flexibility within various spaces.



Effective Compact Solution for Limited Spaces:

Expertly designed for environments where space is at a premium. Despite their compact size, these displays offer an efficient low-profile design for refrigeration and base components, maximizing storage capacity. Equipped with a 7-adjustable shelving system, these units ensure optimal product presentation, allowing for flexible arrangement and accessibility while maintaining a sleek and unobtrusive footprint.



Advanced Smart Technology: (Optional Add-On - Coming Soon)

Brodan's Smart Edition technology, an optional add-on for those looking to enhance operational efficiency, integrates IoT technology to enable real-time communication with our cloud-based platform via Sphery mobile app.

This cutting-edge feature provides detailed system information and monitors the general health of the unit continuously. It also activates self-diagnosis and self-repair processes and even facilitates automated service scheduling, ensuring seamless operations.

CONSTRUCTION AND DESIGN

REFRIGERATED ZONE:

- **Glass Construction:** Double-layer tempered clear glass with black silkscreen print.
- **Insulation:** 60mm thick, Injected high-density polyurethane insulation.
- **Door Type:** Double Swing Doors
- **Door Glass:** 18mm Double Layer with Spacer

SHELVING(REFRIGERATED ZONE):

- **Shelving:** 3 Shelves. Shelf support brackets are made of the same material as the cabinet interior, shelves are adjustable in 30mm (13/ 16") increments
- **Shelf Material:** 6mm Tempered Glass

AMBIENT ZONE:

Glass Construction: Double-layer tempered clear glass with black silkscreen print.

Insulation: 30mm thick, Injected high-density polyurethane insulation.

Door Type: Double Swing Doors

Door Glass: 18mm Double Layer with Spacer

SHELVING(AMBIENT ZONE):

- **Shelving:** 4 Shelves. Shelf support brackets are made of the same material as the cabinet interior, shelves are adjustable in 30mm (13/ 16") increments
- **Shelf Material:** 6mm Tempered Glass

REFRIGERATION SYSTEM:

Main Features:

- **Evaporation Type:** Double fan evaporator
- **Compressor Type:** Hermetic compressor
- **Refrigerant Type:** R404A
- **Defrost System:** Automatic hot gas defrost system

COLORS AND MATERIALS

- **Standard Colors:** Available in three colors, black, white, and stainless-steel edition.
- **Exterior Material:** Made of Galvanized steel with powder coating for White or Black versions, or can be made of durable stainless-steel grade 304.
- **Interior Material:** SS 304 tank and powder-coated galvanized steel interior parts.
- **Coating:** This unit has a no-peel, corrosion-resistant coating that resists fingerprints for an attractive, sanitary front-of-the-house display.

CONTROLS AND LIGHTING:

- **Temperature Control:** Dixell digital controller
- **Lighting:** 3000K LED Lighting
- **Interior Lighting:** 7 3000K daylight integrated magnetic LEDs, easily removable, located undershelf.

OTHERS

- **Caster Wheels:** 4 Low profile caster wheels 50MMX20MM 2 Low profile caster wheels W/ Brakes 50MMX20MM

 **WARRANTY** TWO YEARS warranty on all parts

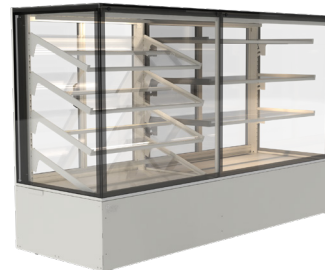
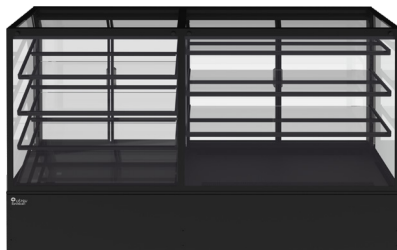

DATA

PRODUCT MODEL*	DIMENSIONS (MM)		WEIGHT (KG)	DOORS SIZES OPENING (MM)		SHELVING DIMENSIONS (MM)		CAPACITY (L)	
SOUDA-CxRA-2100	L 2100 x D 750 x H 1420		450	Refrigerated	894 x 1114 (2x557)	Refrigerated	485 x 1104 x 6 (1)	Refrigerated	515
	Refrigerated	1200 x 750 x 1420		Ambient	894 x 868 (2x434)	Ambient	505 x 1104 x 6 (2)	Ambient	370
	Ambient	900 x 750 x 1420					510 x 858 x 6 (1) 530 x 858 x 6 (2) 550 x 858 x 6 (1)		

PRODUCT MODEL*	DIMENSIONS (MM)		WEIGHT (KG)	DOORS SIZES OPENING (MM)		SHELVING DI MENSIONS (MM)		CAPACITY (L)	
SOUDA-CxRA-1800	L 1800 x D 750 x H 1420		430	Refrigerated	894 x 940 (2x470)	Refrigerated	485 x 904 x 6 (1)	Refrigerated	370
	Refrigerated	1000 x 750 x 1420		Ambient	894 x 798 (2x399)	Ambient	510 x 904 x 6 (2) 510 x 762 x 6 (1)	Ambient	285
	Ambient	800 x 750 x 1420					530 x 762 x 6 (2) 550 x 762 x 6 (1)		

PRODUCT MODEL*	DIMENSIONS (MM)		WEIGHT (KG)	DOORS SIZES OPENING (MM)		SHELVING DIMENSIONS (MM)		CAPACITY (L)	
SOUDA-CxRA-1500	L 1500 x D 750 x H 1420		400	Refrigerated	894 x 840 (2x420)	Refrigerated	485 x 804 x 6 (1)	Refrigerated	329
	Refrigerated	900 x 750 x 1420		Ambient	894 x 599 (1x599)	Ambient	505 x 804 x 6 (2) 510 x 563 x 6 (1)	Ambient	210
	Ambient	600 x 750 x 1420					530 x 563 x 6 (2) 550 x 563 x 6 (1)		

*x Indication of the location of refrigerated zone

ELECTRICAL SPECIFICATIONS

POWER SUPPLY: The unit is pre-wired and ready to connect to: 240 / 50 - 60 / 1 phase, 13-amp dedicated outlet, type G



PRODUCT MODEL	HORSE POWER (HP)	AMPS	REFRIGERANT CHARGE (G)	REFRIGERANT TYPE	TEMPERATURE RANGE (OC)	VOLTAGE /HERTZ /PHASE	POWER (KW)
SOUDA-CxRA-2100	3/4	6.8	500	R404A	from -1 to +7 C	240v / 50-60 / 1 phase	1.5
SOUDA-CxRA-1800	3/4	6.8	500	R404A	from -1 to +7 C	240v / 50-60 / 1 phase	1.5
SOUDA-CxRA-1500	3/8	4.8	300	R404A	from -1 to +7 C	240v / 50-60 / 1 phase	1.0

* The technical specifications are subject to change without prior notice as we continue to improve our products. Please contact our customer support for the most up-to-date information.

ORDERING

We offer standard colors (Black, White, Stainless Steel)

and untraditional customized colors. If you want to get different colors please contact our sales representative.

Right Refrigerated (CRRRA)		
PRODUCT MODEL	COLORS	
SOUDA-CRRRA-2100-BLK		
SOUDA-CRRRA-1800-BLK		
SOUDA-CRRRA-1500-BLK		
SOUDA-CRRRA-2100-WHT		
SOUDA-CRRRA-1800-WHT		
SOUDA-CRRRA-1500-WHT		
SOUDA-CRRRA-2100-SS		
SOUDA-CRRRA-1800-SS		
SOUDA-CRRRA-1500-SS		

Left Refrigerated (CLRA)		
PRODUCT MODEL	COLORS	
SOUDA-CLRA-2100-BLK		
SOUDA-CLRA-1800-BLK		
SOUDA-CLRA-1500-BLK		
SOUDA-CLRA-2100-WHT		
SOUDA-CLRA-1800-WHT		
SOUDA-CLRA-1500-WHT		
SOUDA-CLRA-2100-SS		
SOUDA-CLRA-1800-SS		
SOUDA-CLRA-1500-SS		

PLAN VIEW

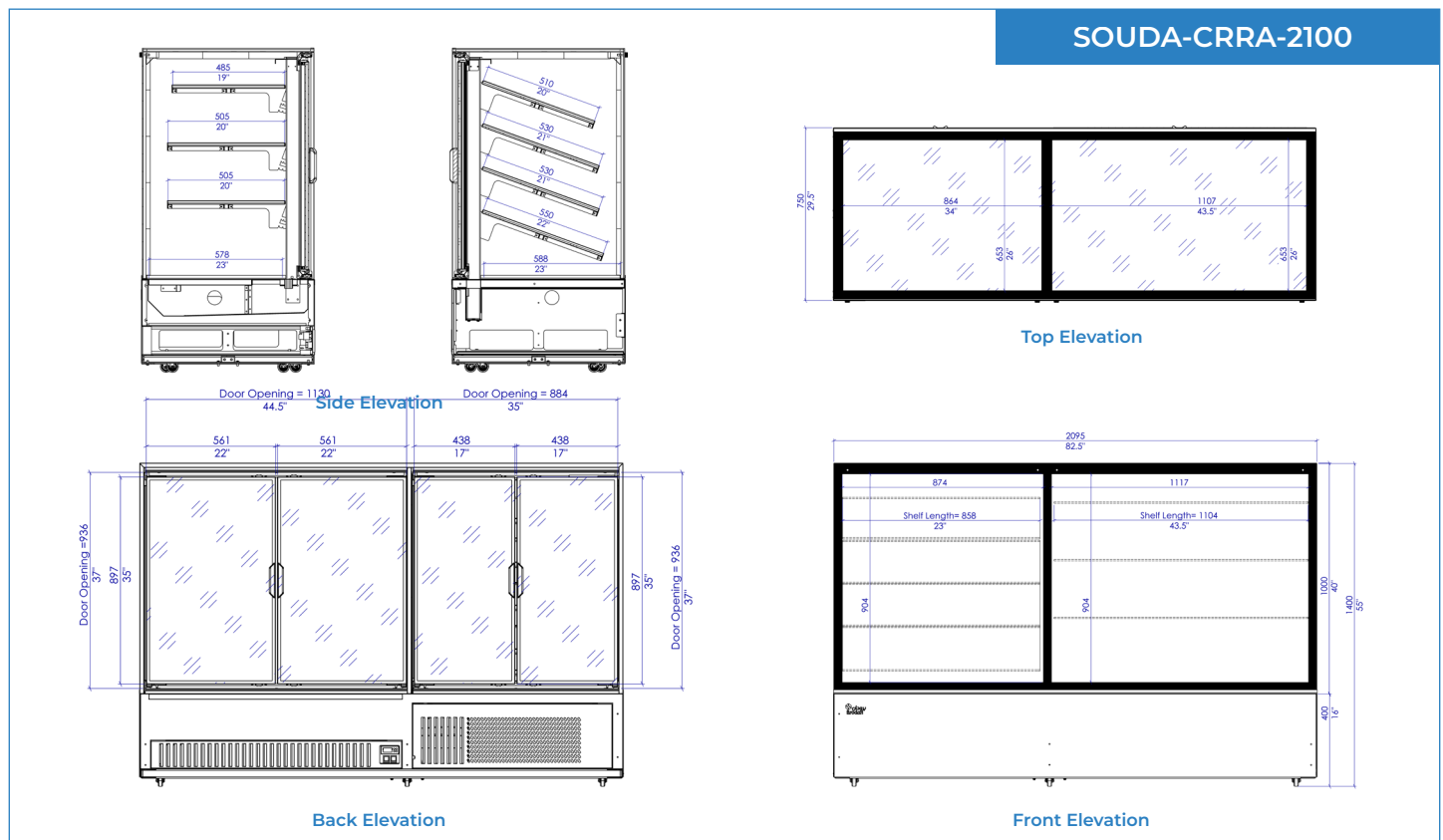

PLAN VIEW

SOUDA-CLRA-1800

LEFT

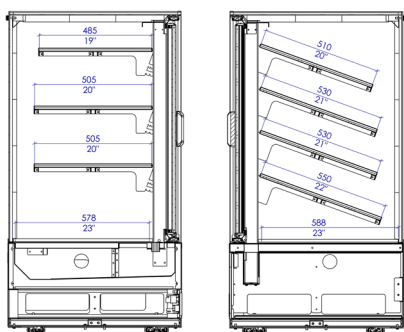

Side Elevation

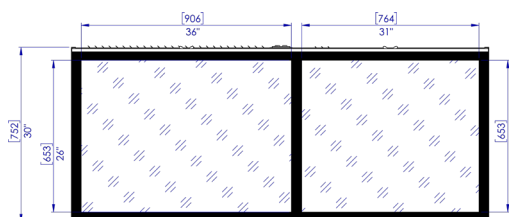

Top Elevation

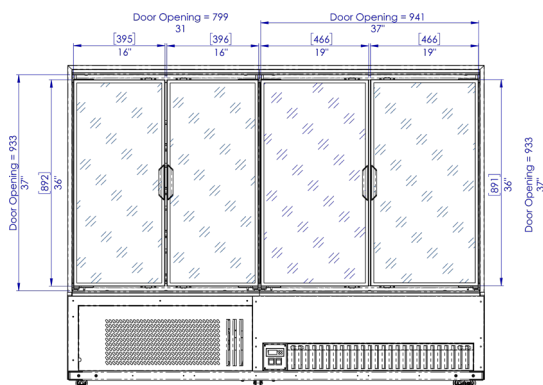

Back Elevation

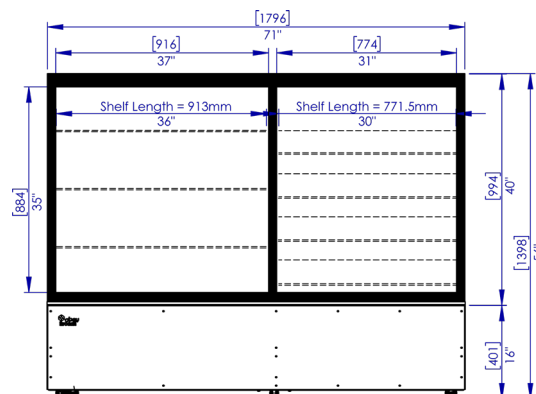

Front Elevation

SOUDA-CRRA-1500

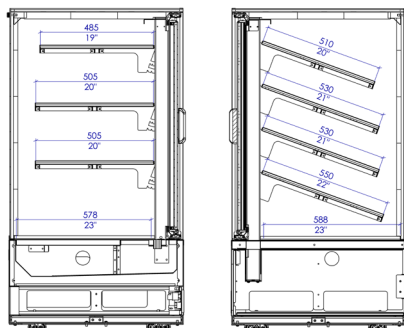

Side Elevation

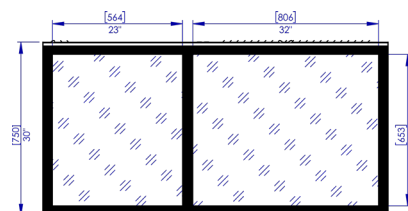

Top Elevation

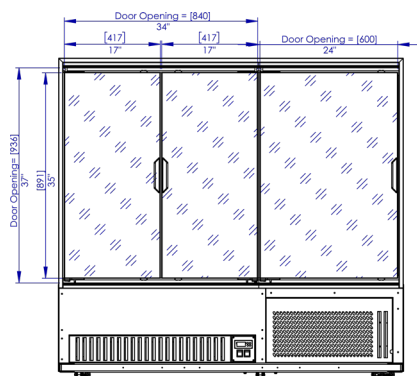

Back Elevation

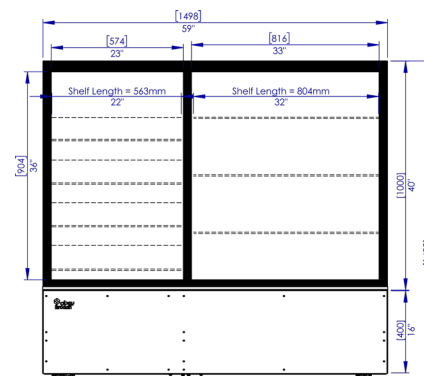

Front Elevation

CONTACT

Website: www.brodan.co

Email: info@brodan.co

Phone: 920035109

Address: Miran Factory for Industry, PO 1219 / 34334, 77-83 Street, Building # 8396, Dammam, 2nd Industrial City, Eastern Province, Saudi Arabia